

G ELECTRICAL WIRING ROUTING

□ : Location of Connector Joining Wire Harness and Wire Harness

▽ : Location of Ground Points

[5S-FE]

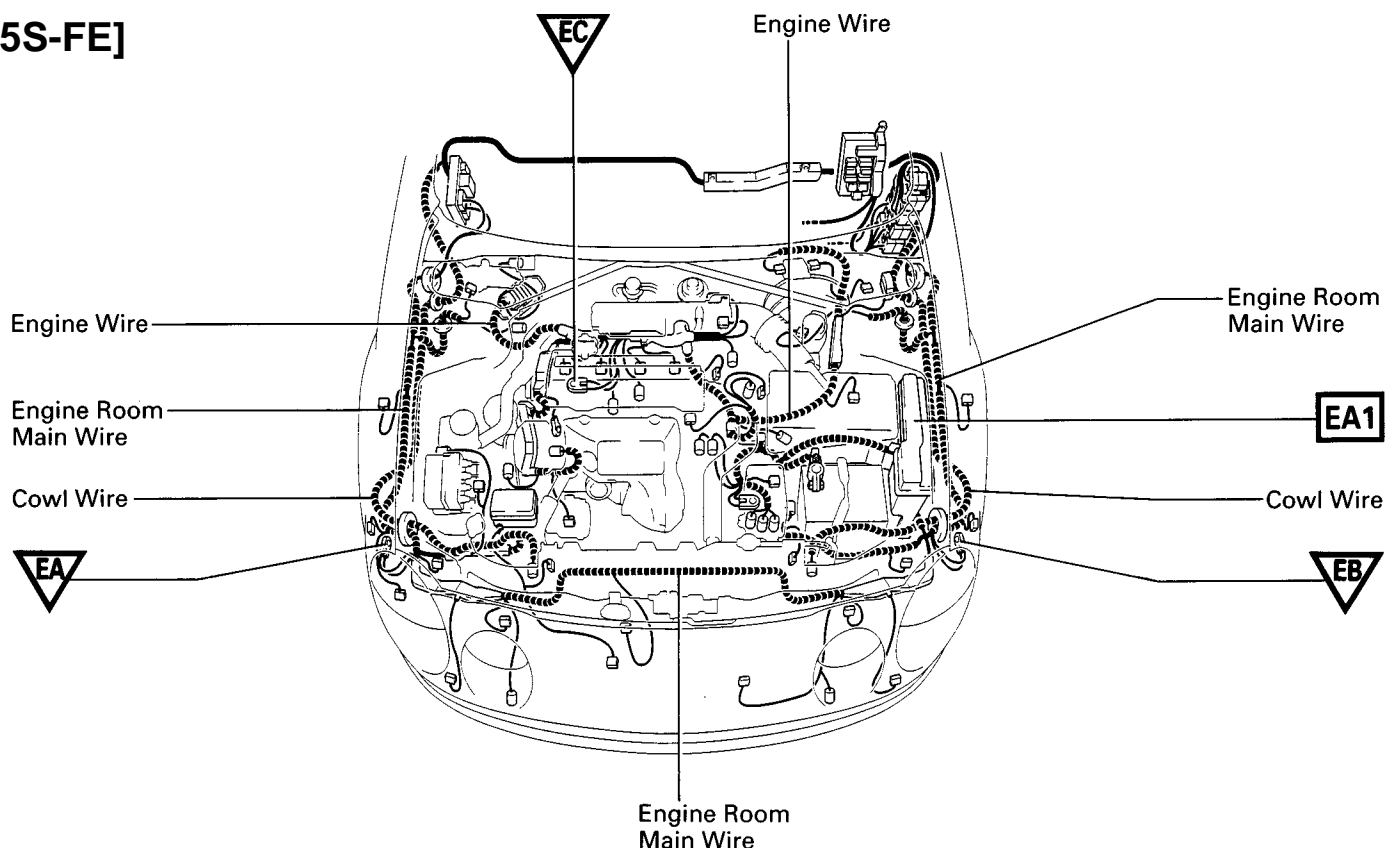

○ : Location of Splice Points

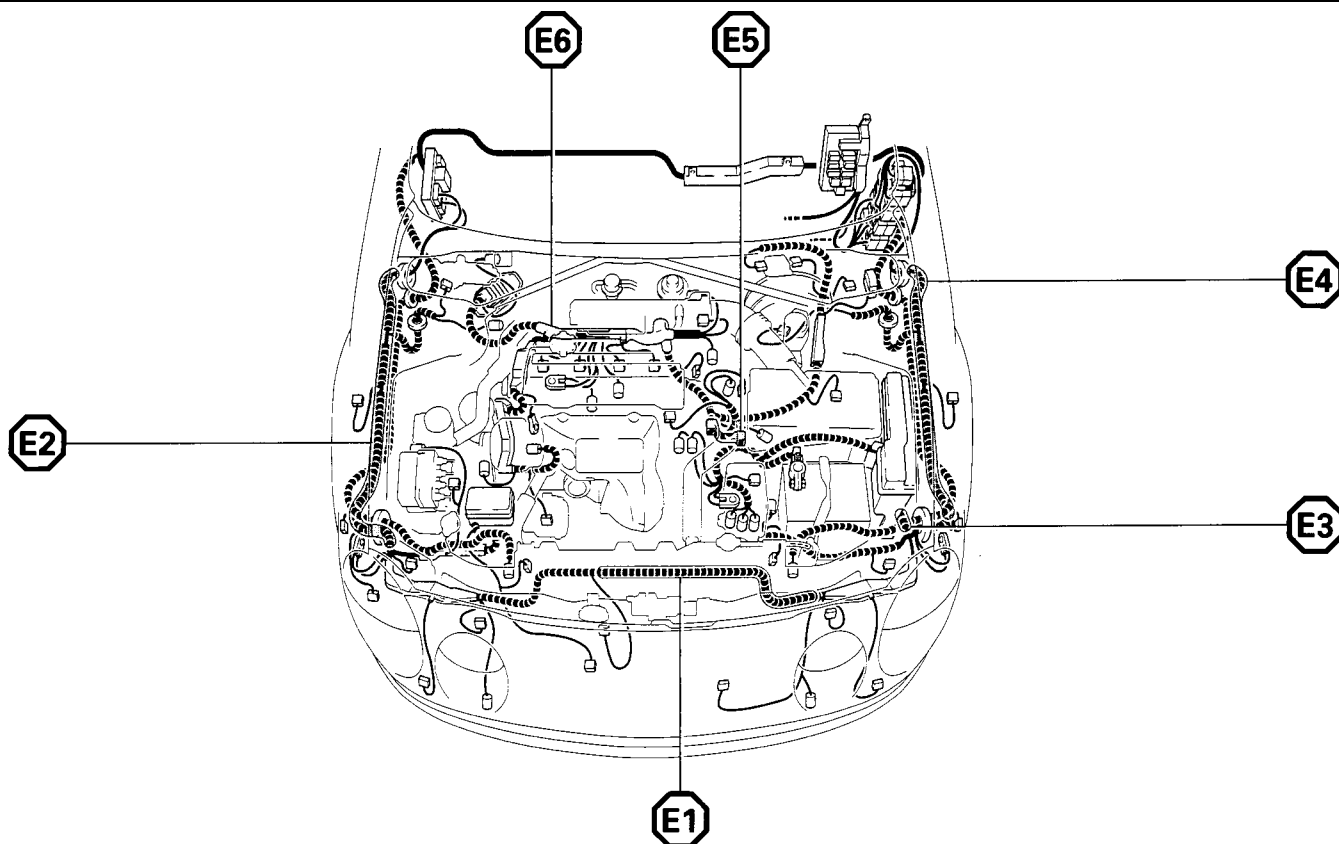

Connector Joining Wire Harness and Wire Harness

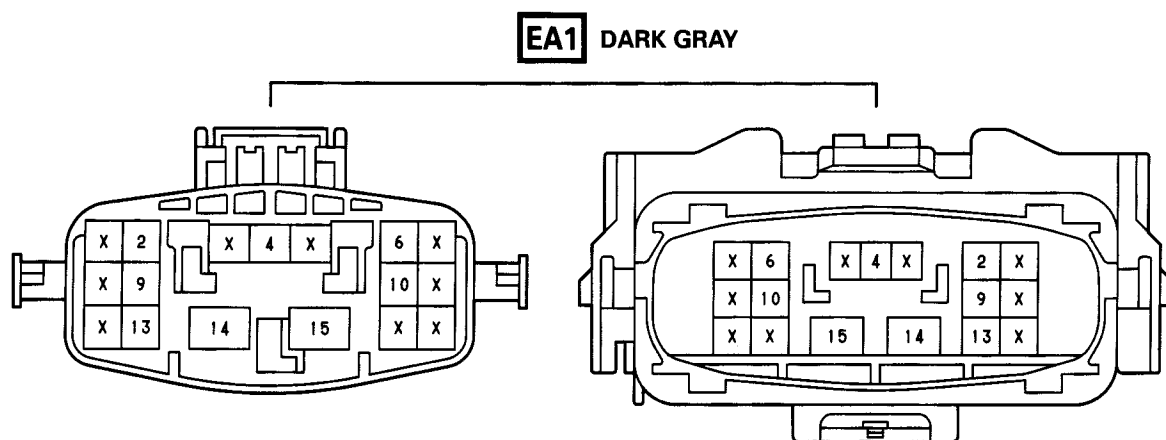

CODE	JOINING WIRE HARNESS AND WIRE HARNESS (CONNECTOR LOCATION)
EA1	ENGINE WIRE AND ENGINE ROOM MAIN WIRE (INSIDE OF R/B NO.2)

G ELECTRICAL WIRING ROUTING

□ : Location of Connector Joining Wire Harness and Wire Harness

▽ : Location of Ground Points

[7A-FE]

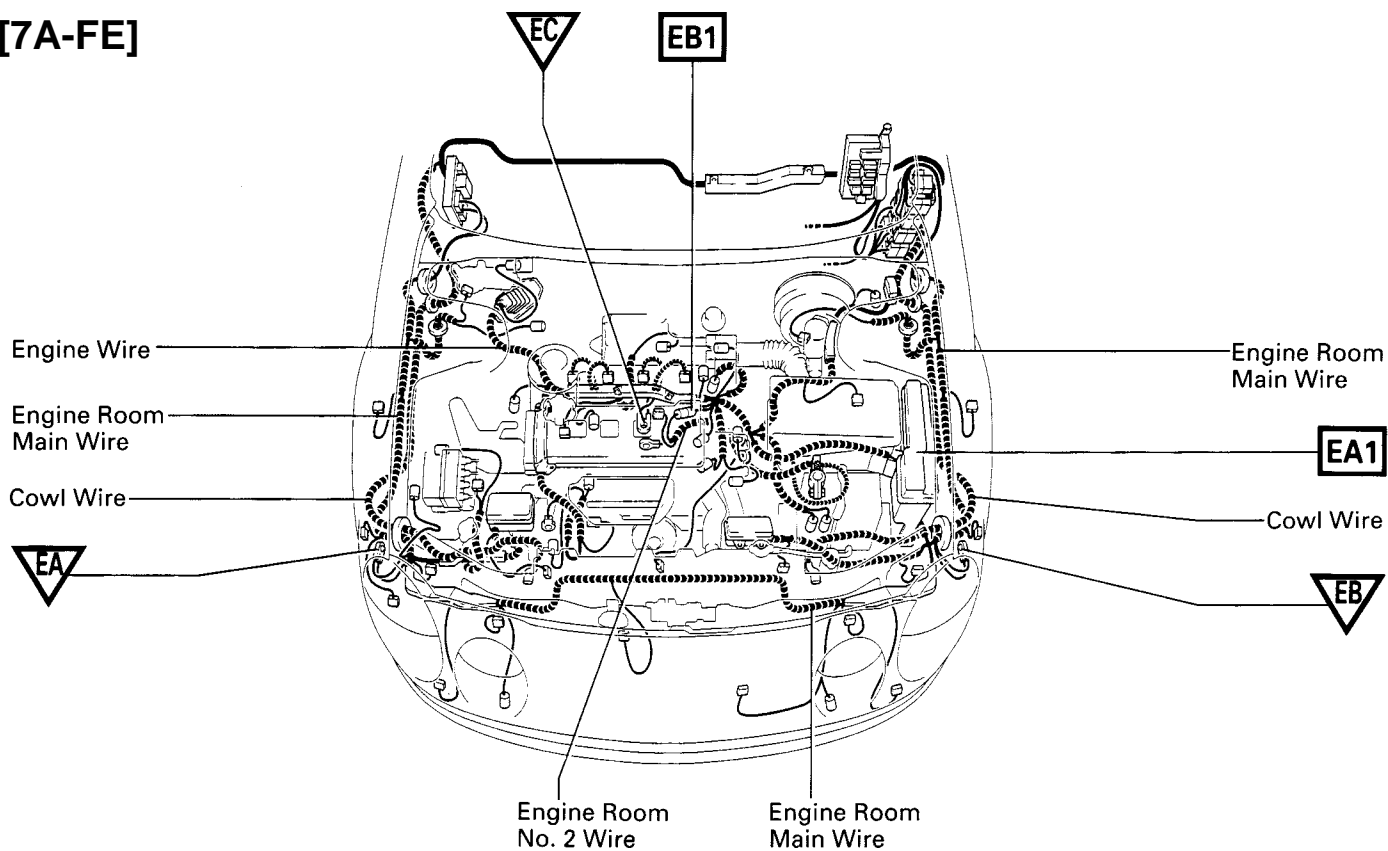

○ : Location of Splice Points

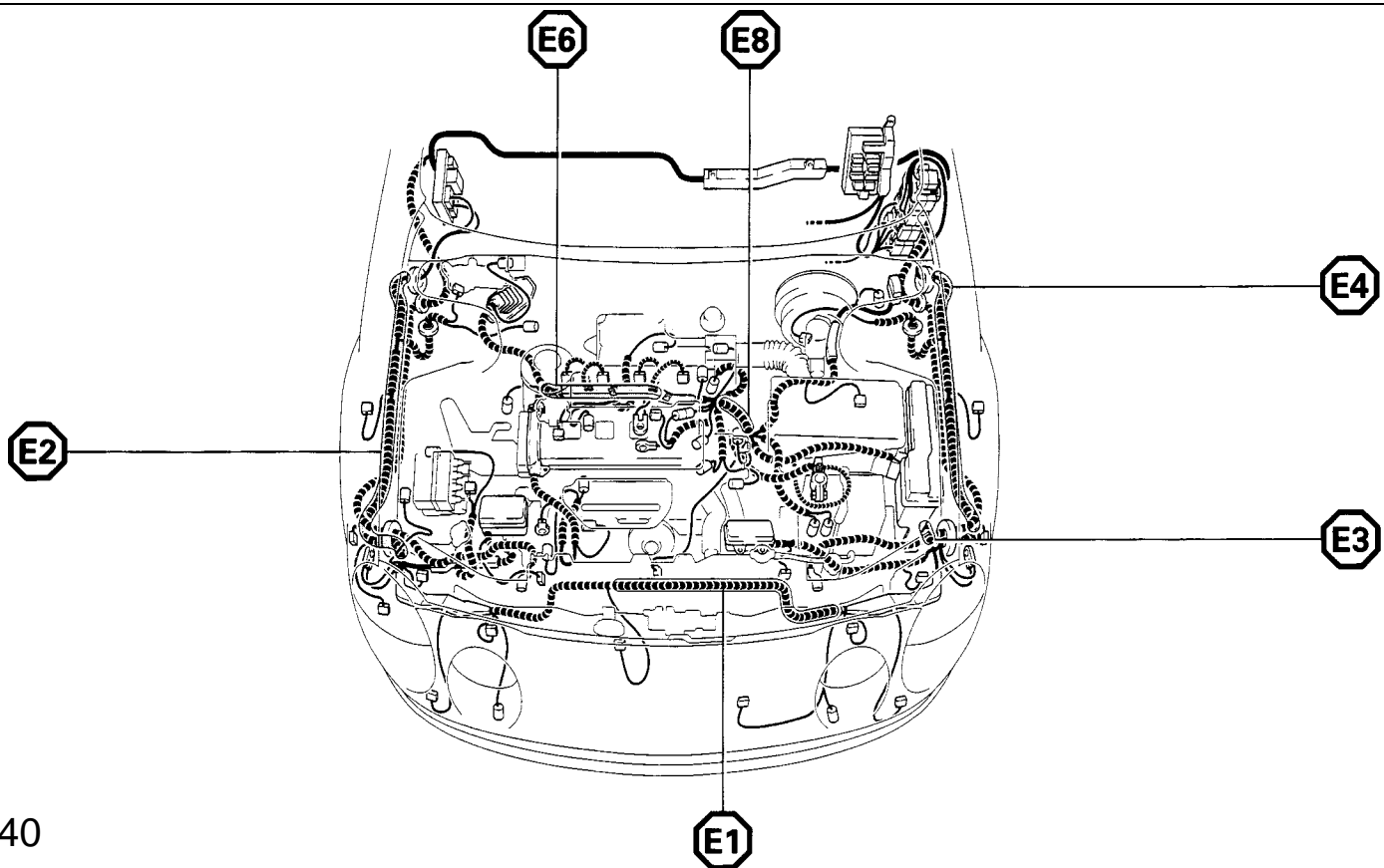

Connector Joining Wire Harness and Wire Harness

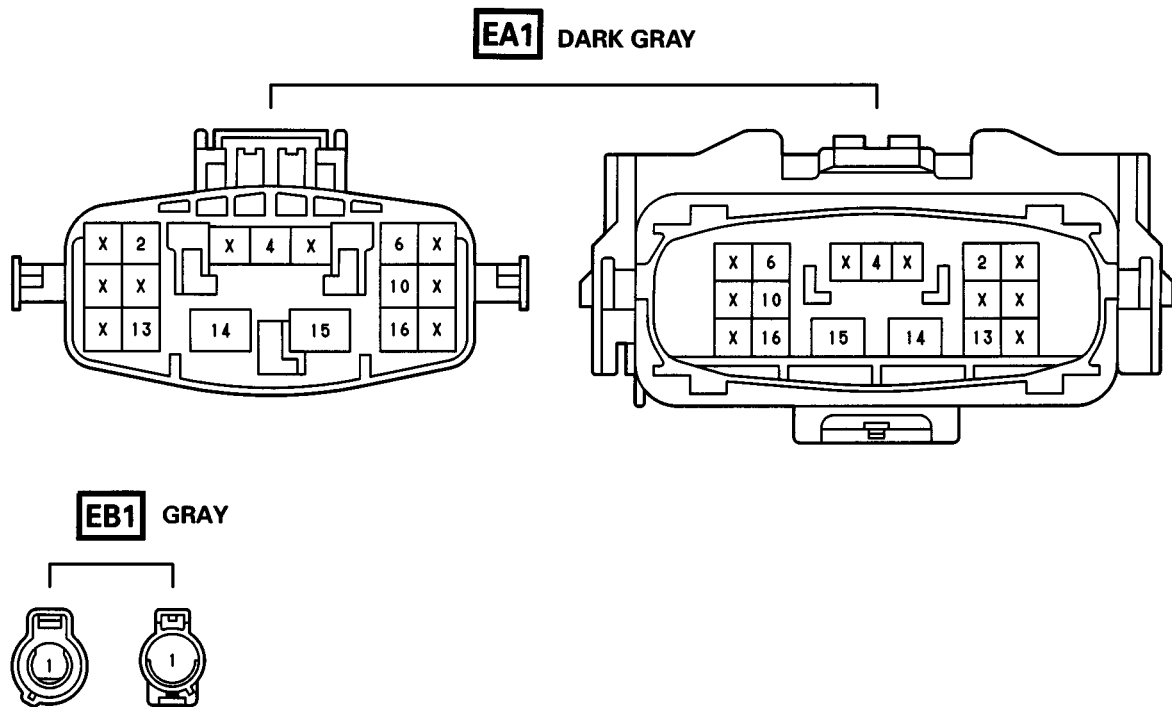

CODE	JOINING WIRE HARNESS AND WIRE HARNESS (CONNECTOR LOCATION)
EA1	ENGINE WIRE AND ENGINE ROOM MAIN WIRE (INSIDE OF R/B NO.2)
EB1	ENGINE ROOM NO.2 WIRE AND ENGINE WIRE (NEAR THE STARTER)

G ELECTRICAL WIRING ROUTING

□ : Location of Connector Joining Wire Harness and Wire Harness

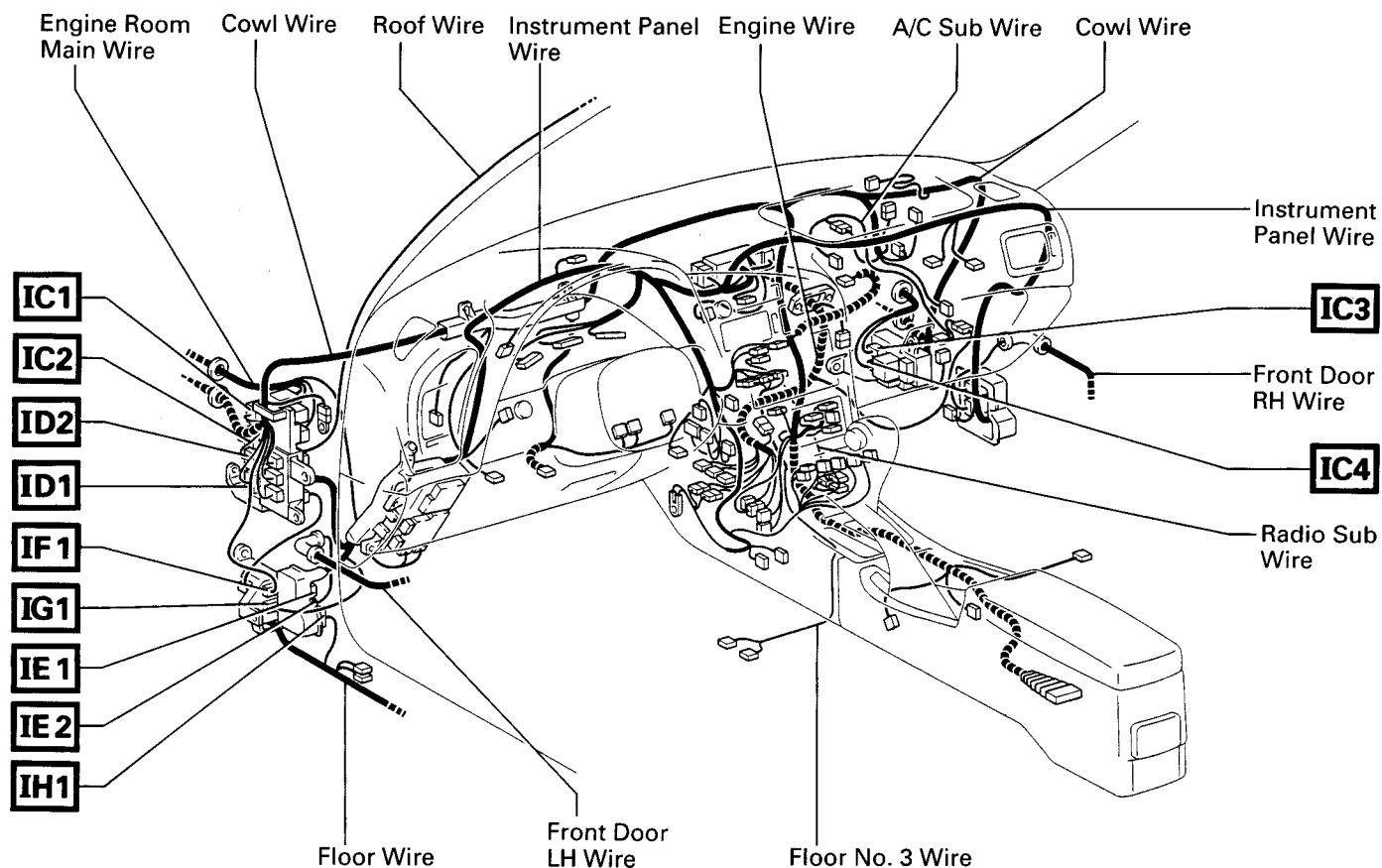

▽ : Location of Ground Points

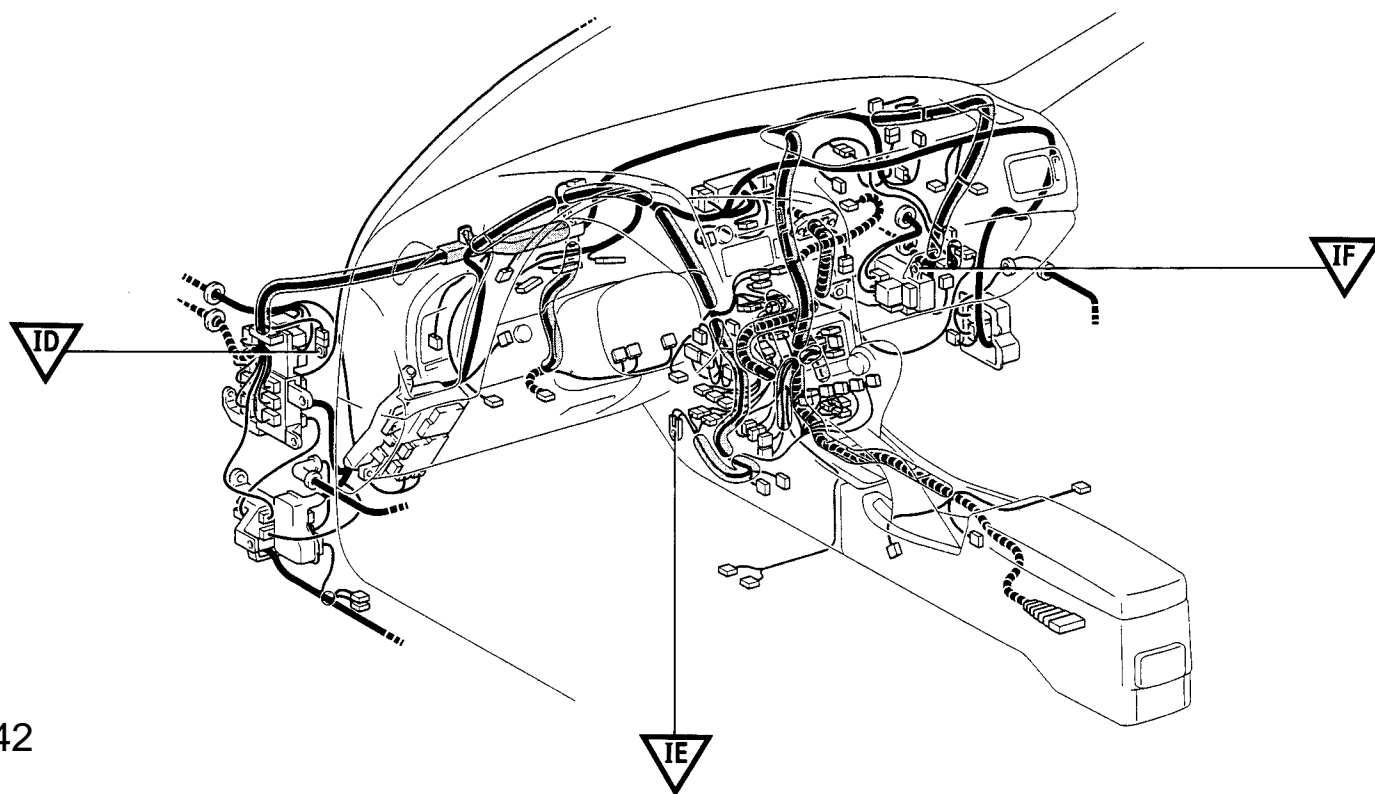

Connector Joining Wire Harness and Wire Harness

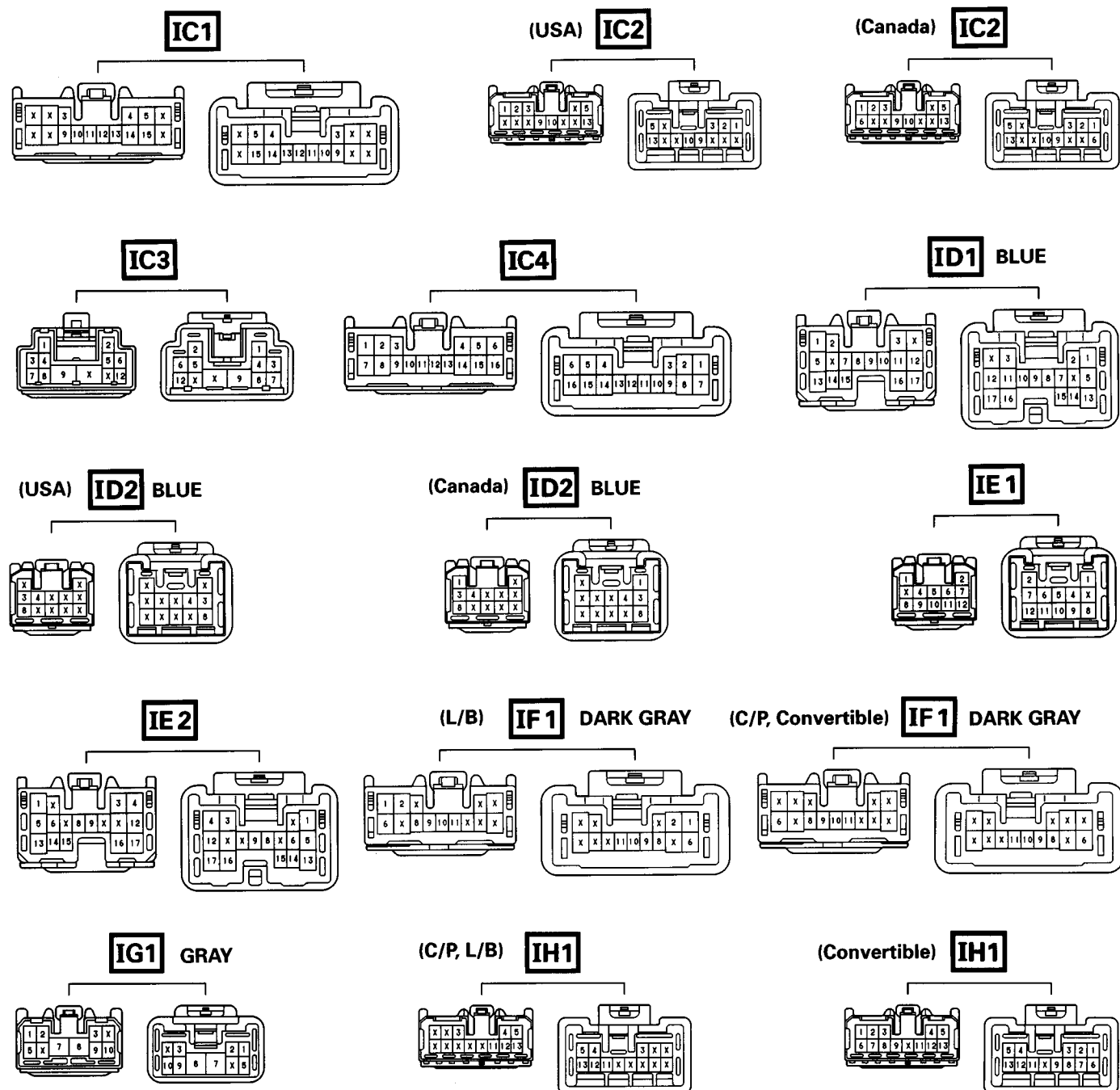

CODE	JOINING WIRE HARNESS AND WIRE HARNESS (CONNECTOR LOCATION)
IC1	ENGINE ROOM MAIN WIRE AND COWL WIRE (LEFT KICK PANEL)
IC2	ENGINE ROOM MAIN WIRE AND COWL WIRE (LEFT KICK PANEL)
IC3	ENGINE ROOM MAIN WIRE AND COWL WIRE (INSIDE OF R/B NO.4)
IC4	ENGINE ROOM MAIN WIRE AND COWL WIRE (INSIDE OF R/B NO.4)
ID1	INSTRUMENT PANEL WIRE AND COWL WIRE (LEFT KICK PANEL)
ID2	INSTRUMENT PANEL WIRE AND COWL WIRE (LEFT KICK PANEL)
IE1	FRONT DOOR LH WIRE AND INSTRUMENT PANEL WIRE (LEFT KICK PANEL)
IE2	FRONT DOOR LH WIRE AND INSTRUMENT PANEL WIRE (LEFT KICK PANEL)
IF1	COWL WIRE AND FLOOR WIRE (LEFT KICK PANEL)
IG1	INSTRUMENT PANEL WIRE AND FLOOR WIRE (LEFT KICK PANEL)
IH1	FLOOR WIRE AND INSTRUMENT PANEL WIRE (LEFT KICK PANEL)

G ELECTRICAL WIRING ROUTING

□ : Location of Connector Joining Wire Harness and Wire Harness

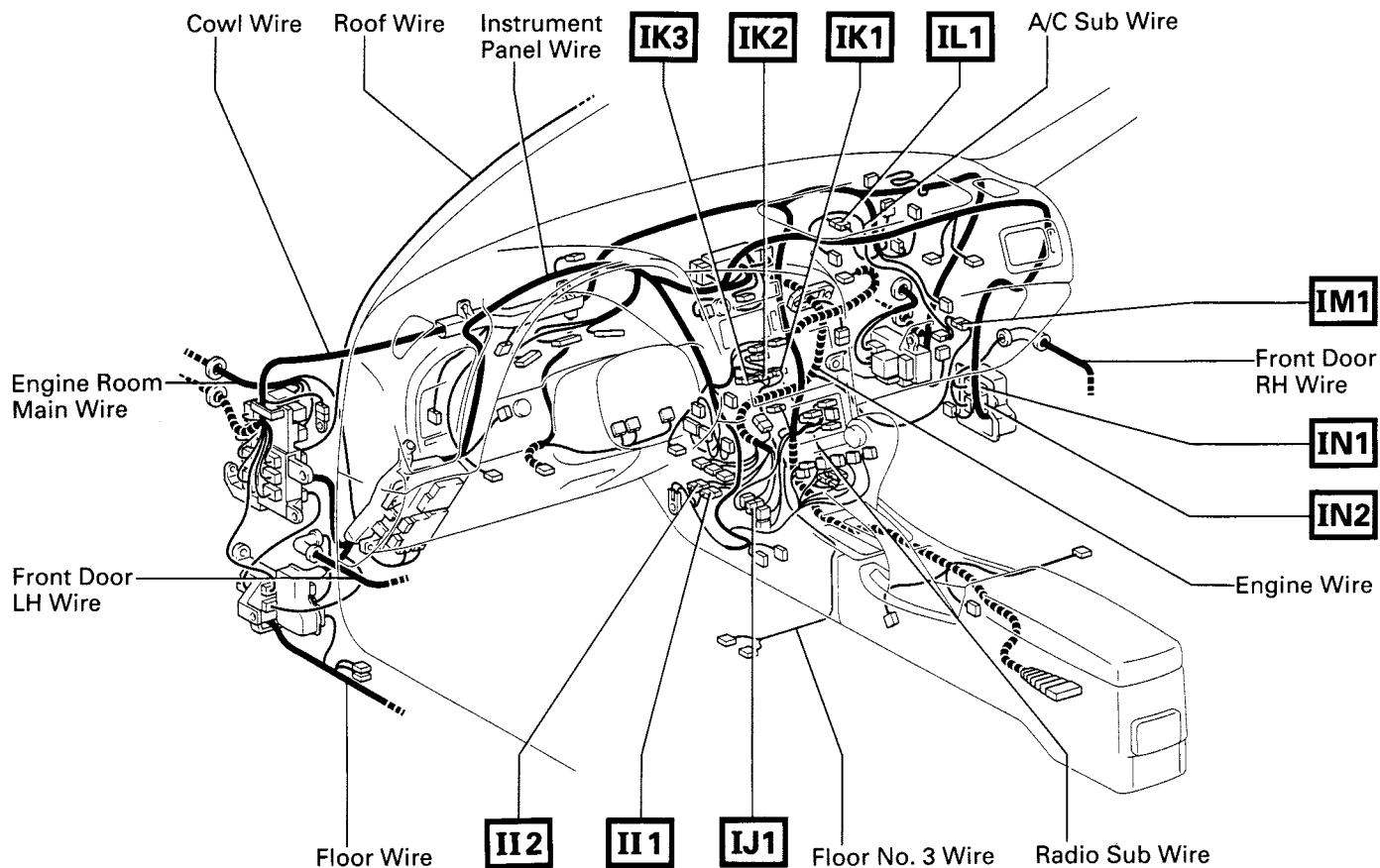

○ : Location of Splice Points

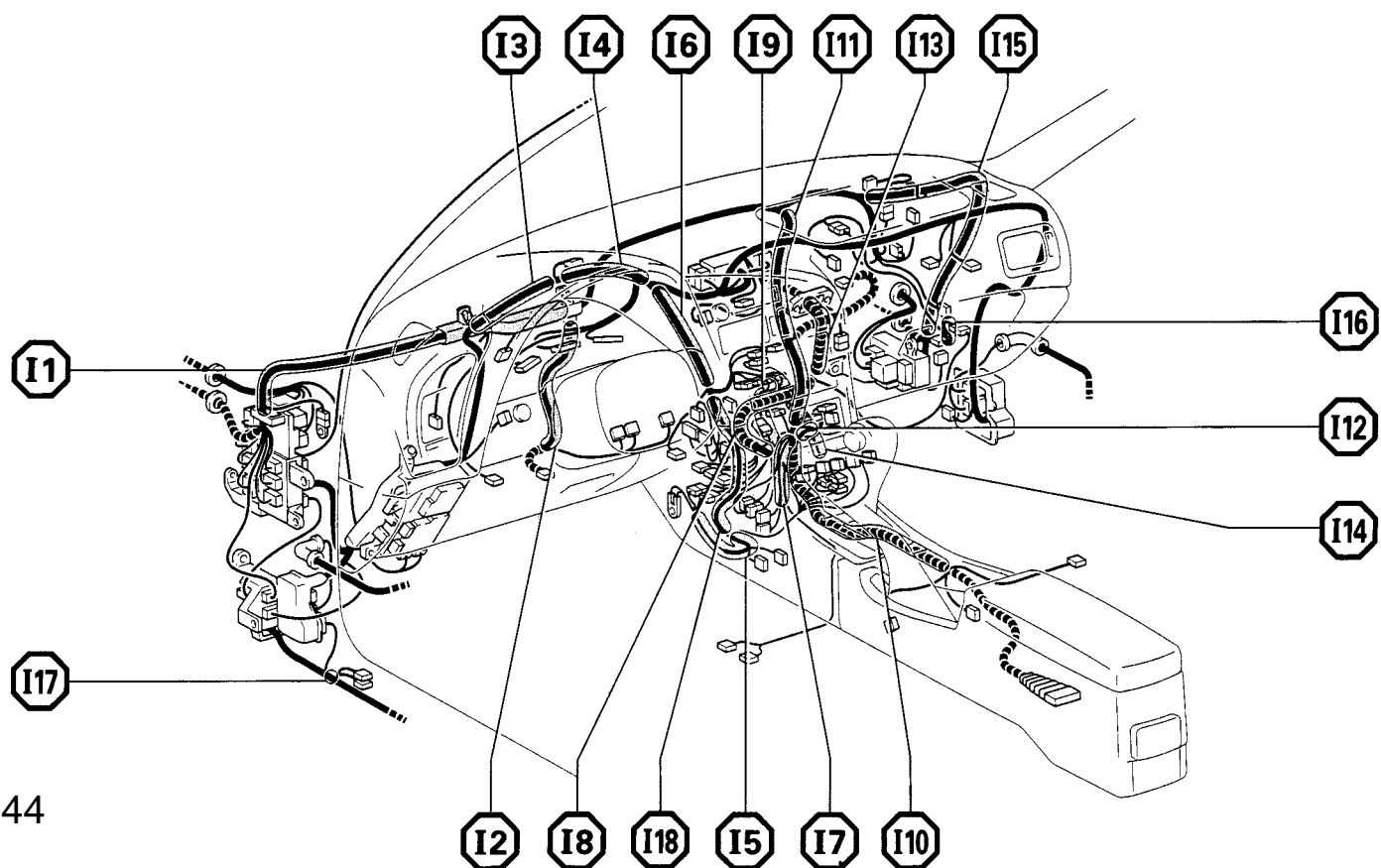

Connector Joining Wire Harness and Wire Harness

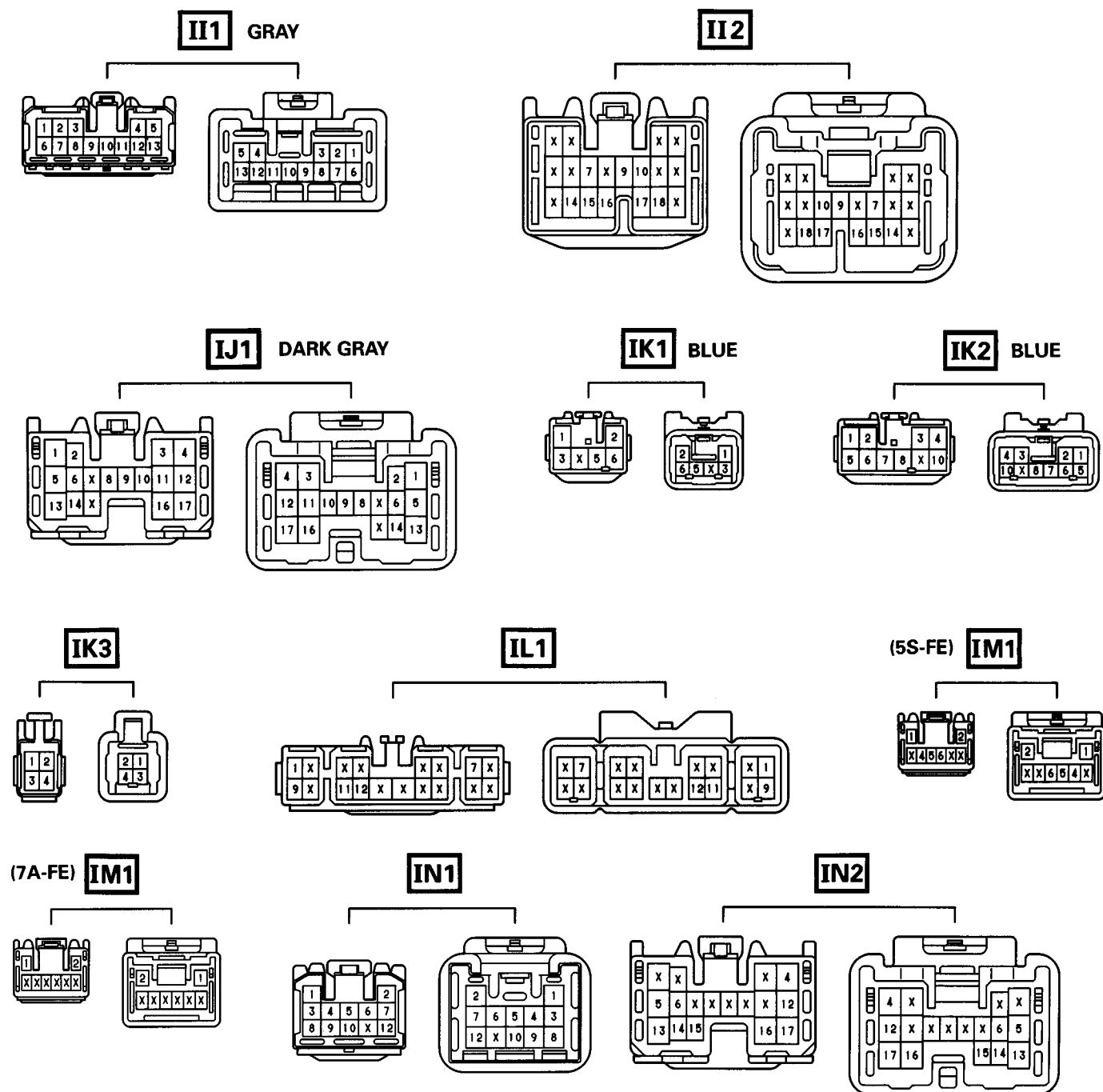

CODE	JOINING WIRE HARNESS AND WIRE HARNESS (CONNECTOR LOCATION)
II1	ENGINE WIRE AND INSTRUMENT PANEL WIRE (NEAR THE ENGINE CONTROL MODULE)
II2	ENGINE WIRE AND INSTRUMENT PANEL WIRE (NEAR THE ENGINE CONTROL MODULE)
IJ1	ENGINE WIRE AND COWL WIRE (INSTRUMENT PANEL CENTER)
IK1	INSTRUMENT PANEL WIRE AND FLOOR NO.3 WIRE (BEHIND THE RADIO AND PLAYER)
IK2	INSTRUMENT PANEL WIRE AND FLOOR NO.3 WIRE (BEHIND THE RADIO AND PLAYER)
IK3	INSTRUMENT PANEL WIRE AND FLOOR NO.3 WIRE (BEHIND THE RADIO AND PLAYER)
IL1	COWL WIRE AND A/C SUB WIRE (UPPER THE A/C UNIT)
IM1	ENGINE WIRE AND A/C SUB WIRE (NEAR THE BLOWER MOTOR)
IN1	FRONT DOOR RH WIRE AND INSTRUMENT PANEL WIRE (RIGHT KICK PANEL)
IN2	FRONT DOOR RH WIRE AND INSTRUMENT PANEL WIRE (RIGHT KICK PANEL)

G ELECTRICAL WIRING ROUTING

□ : Location of Connector Joining Wire Harness and Wire Harness

▽ : Location of Ground Points

[L/B]

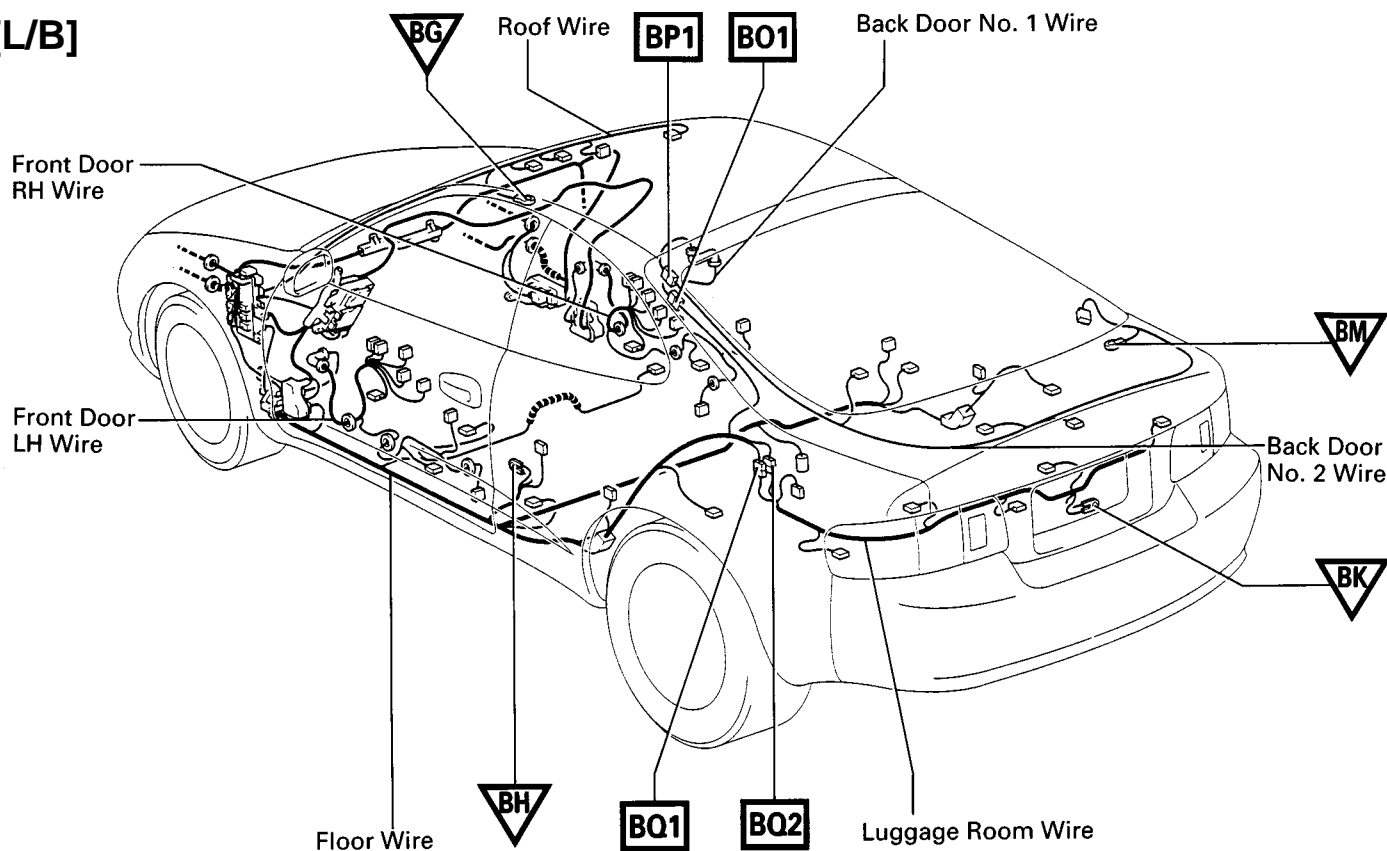

○ : Location of Splice Points

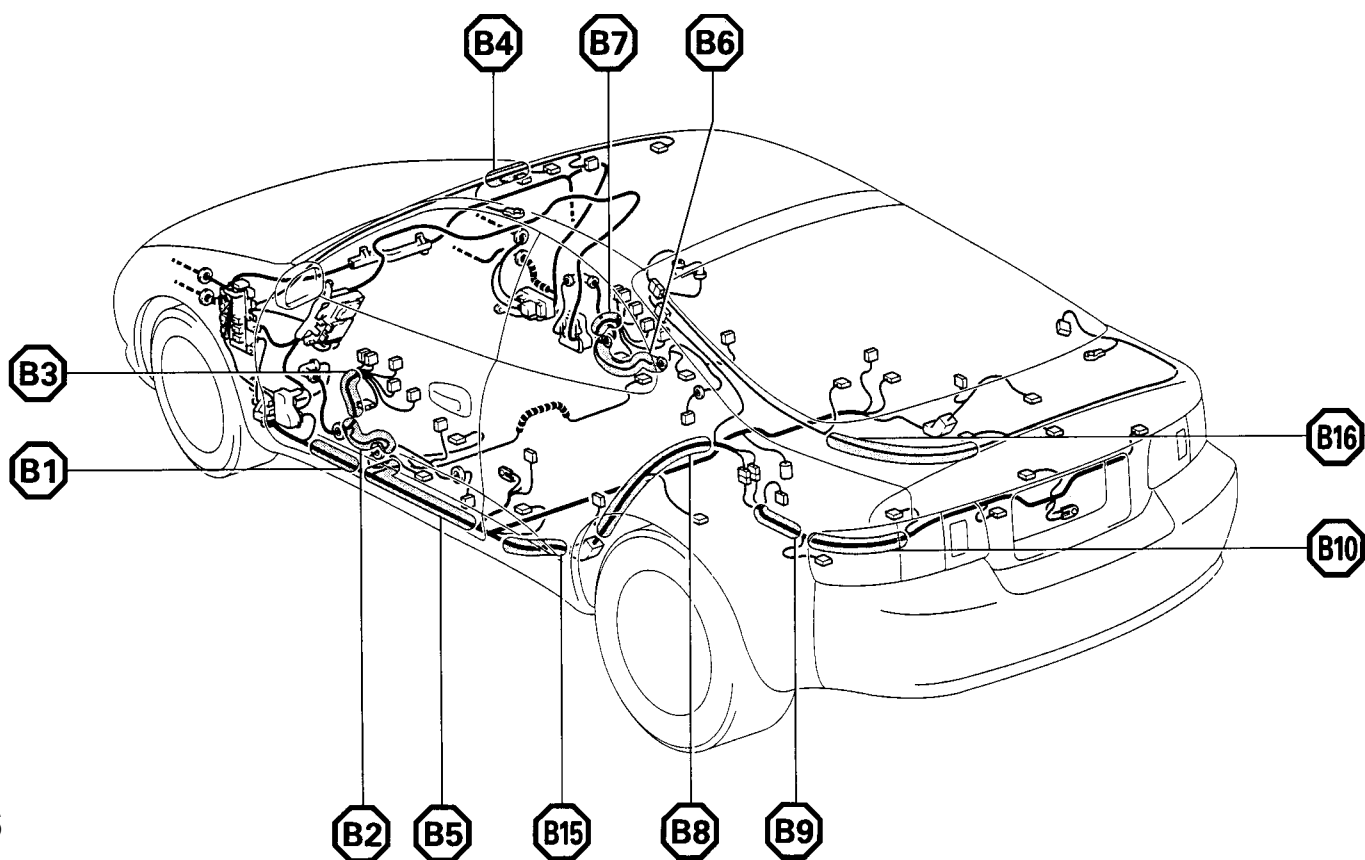

Connector Joining Wire Harness and Wire Harness

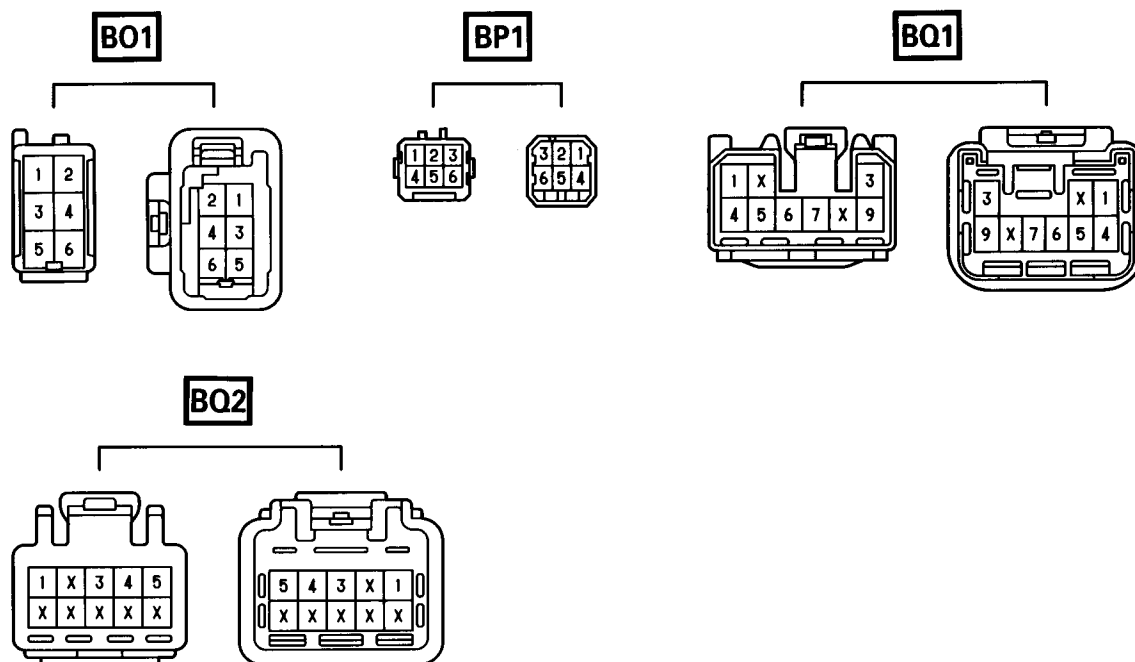

CODE	JOINING WIRE HARNESS AND WIRE HARNESS (CONNECTOR LOCATION)
BO1	BACK DOOR NO.1 WIRE AND FLOOR WIRE (BACK DOOR UPPER LEFT)
BP1	BACK DOOR NO.2 WIRE AND BACK DOOR NO.1 WIRE (BACK DOOR UPPER LEFT)
BQ1	FLOOR WIRE AND LUGGAGE ROOM WIRE (LUGGAGE ROOM LEFT)
BQ2	

G ELECTRICAL WIRING ROUTING

□ : Location of Connector Joining Wire Harness and Wire Harness

▽ : Location of Ground Points

[C/P]

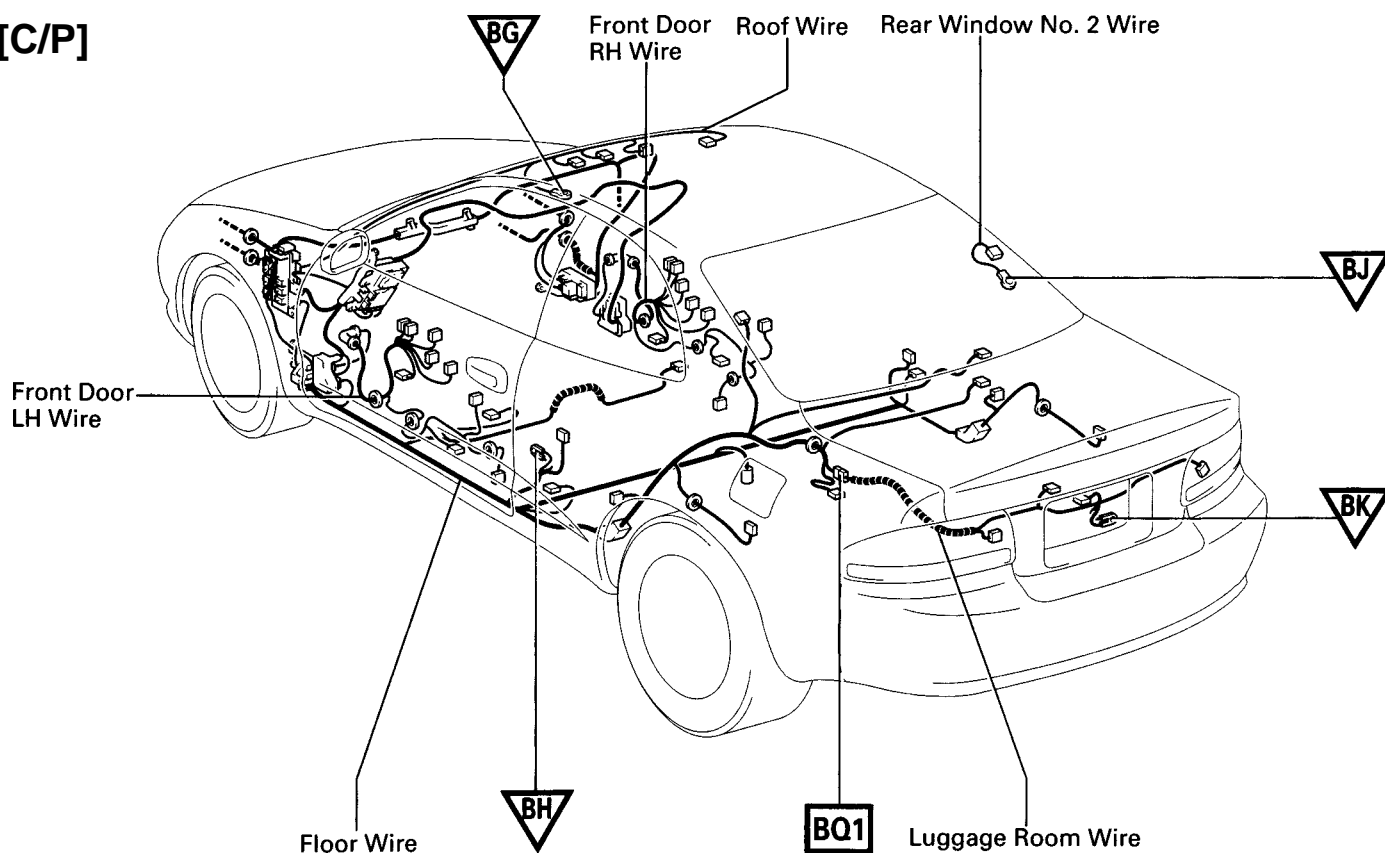

○ : Location of Splice Points

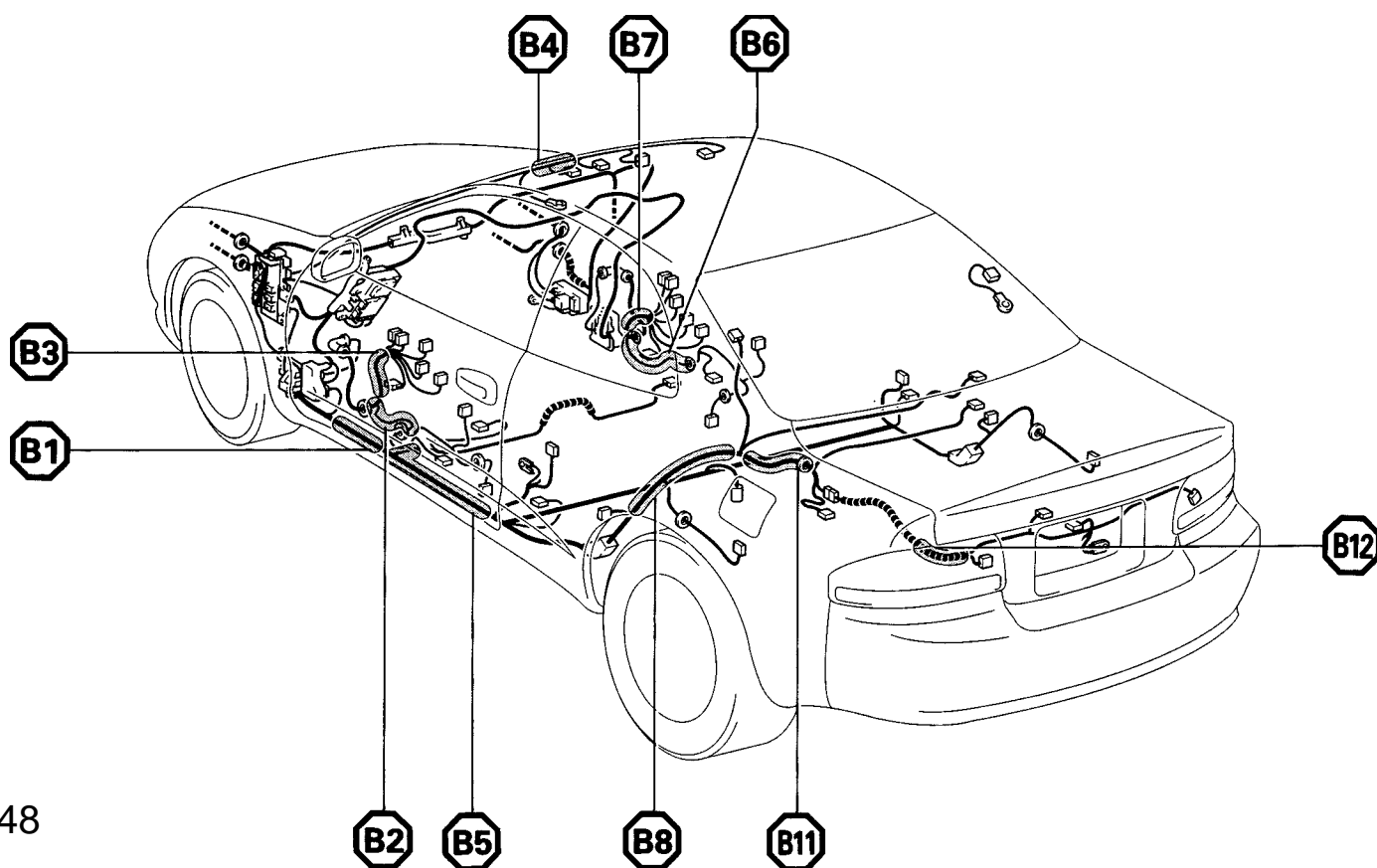

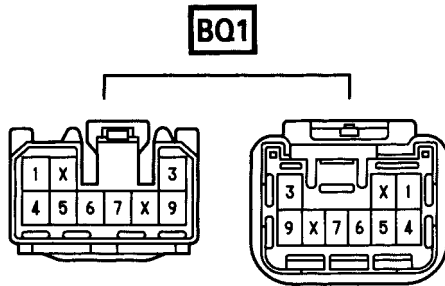

CODE	JOINING WIRE HARNESS AND WIRE HARNESS (CONNECTOR LOCATION)
BQ1	FLOOR WIRE AND LUGGAGE ROOM WIRE (LUGGAGE ROOM LEFT)

G ELECTRICAL WIRING ROUTING

□ : Location of Connector Joining Wire Harness and Wire Harness

▽ : Location of Ground Points

[Convertible]

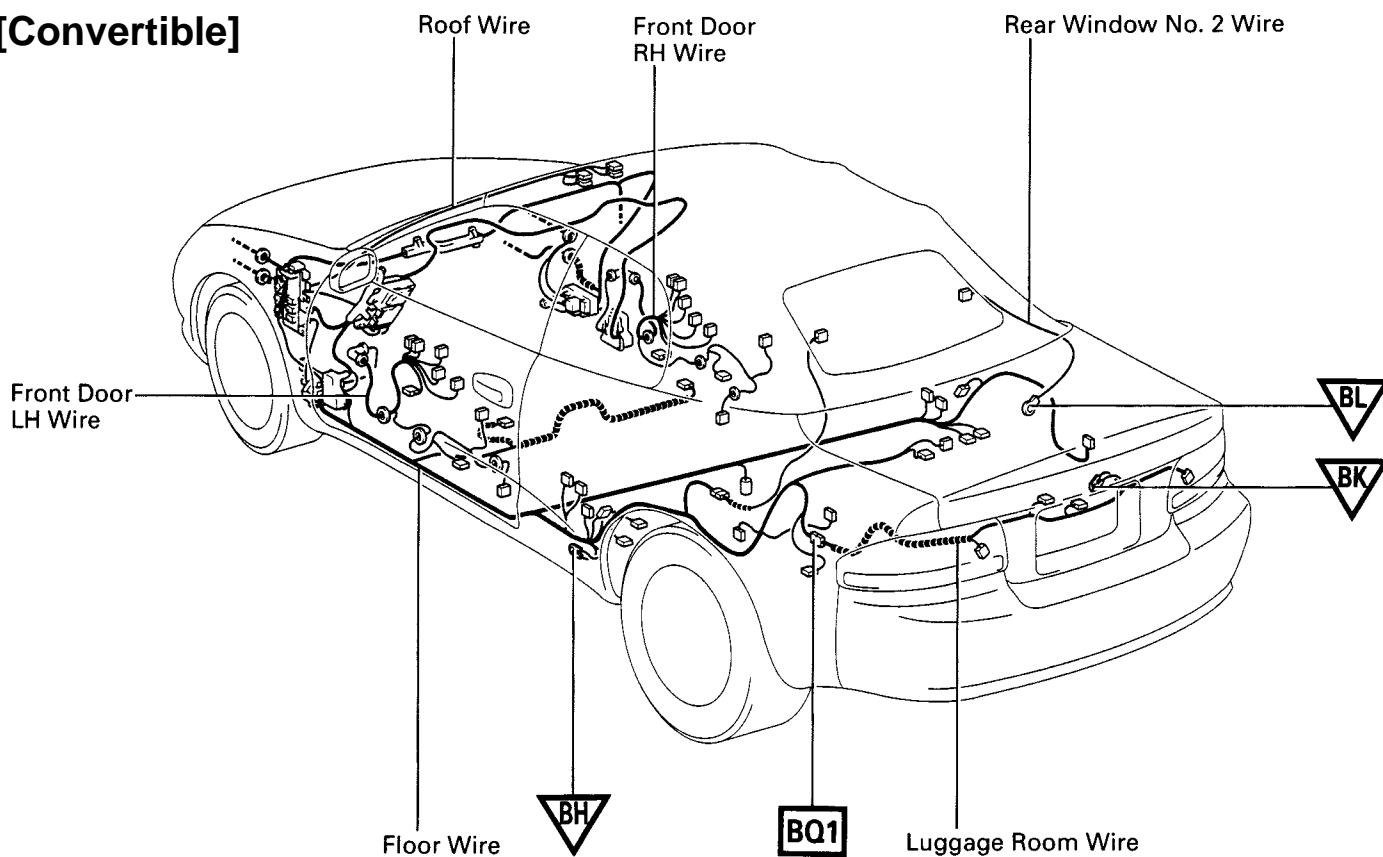

○ : Location of Splice Points

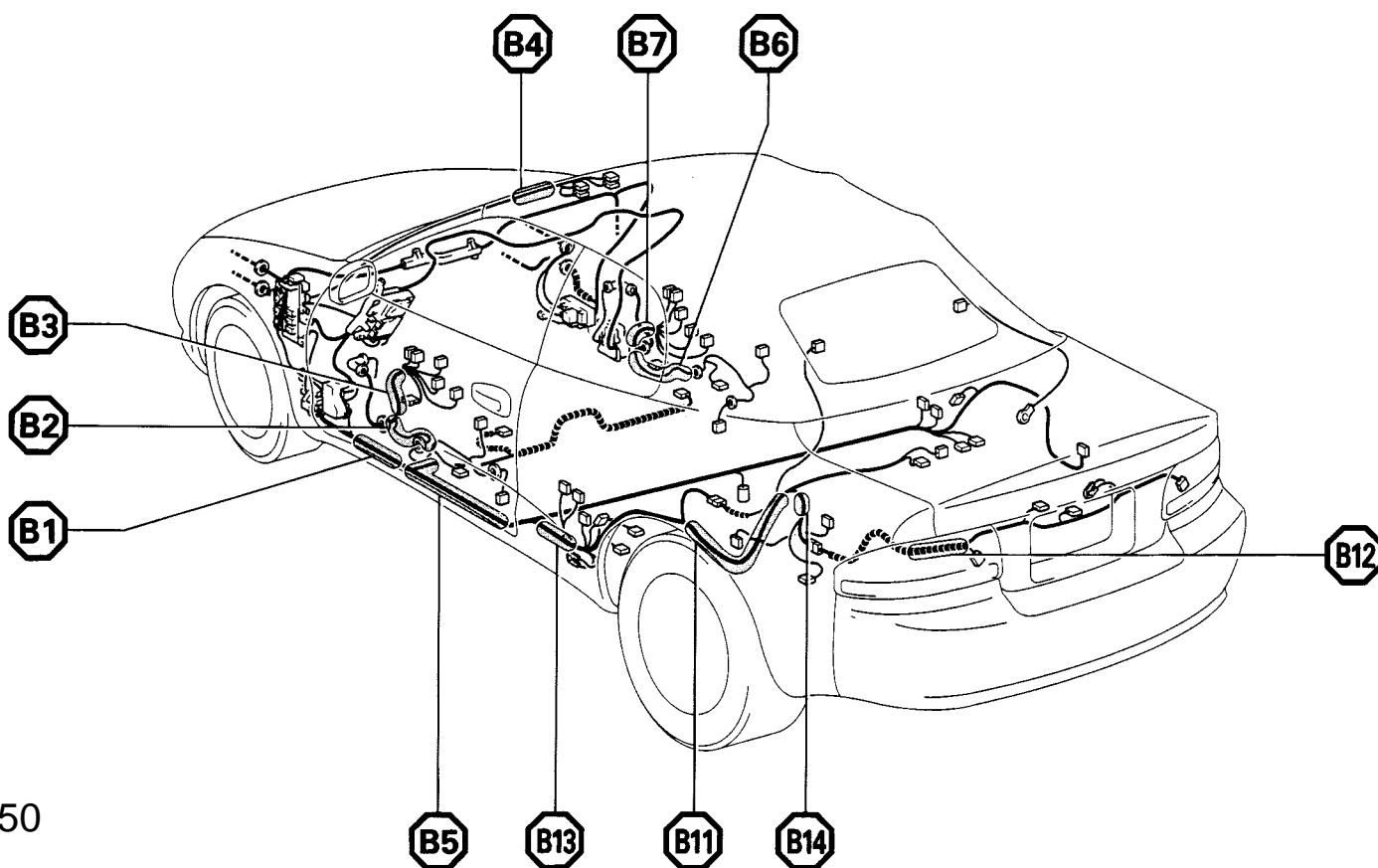

Connector Joining Wire Harness and Wire Harness

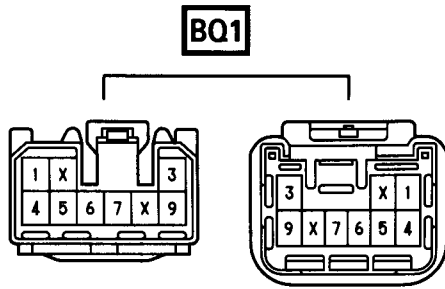

CODE	JOINING WIRE HARNESS AND WIRE HARNESS (CONNECTOR LOCATION)
BQ1	FLOOR WIRE AND LUGGAGE ROOM WIRE (LUGGAGE ROOM LEFT)